

MUB

Square duct fans



- Speed-controllable
- Removable panels
- Discharge direction can be adjusted on site
- Can be installed in any position
- Low noise operation

Casing

Self-supporting aluminium frame construction with high impact resistant PA6 corners. 20 mm or 30 mm mineral wool acoustic and thermal insulation.

Motor

Depending on the version, equipped with voltage controllable external rotor motors or frequency inverter controllable IE2 or IE3 standard motors.

Impeller geometry

3D profiled centrifugal impeller with backward curved blades.

Output control

Depending on the version, output control via a transformer, star-delta switching or frequency inverter is possible.

Motor protection

Integrated thermal contacts with cables for connection to a motor protection switching device. The IE2/IE3 motors are equipped with PTC thermistors with cables for connection to a motor protection switching device.

You can find more information in our online catalogue on www.systemair.com

Accessories



CCM
Connection
Page 387



CCMI
Connection, iso.
Page 387



FGV
Flex. connection
Page 385



SD-MUB
Vibration pad
Page 388



SRKG
Shutter
Page 375



UGS
Flexible adapter
Page 386



WSD MUB
Weather roof
Page 386



WSG
Weather protection
Page 386

Electrical accessories



STDT
Motor protection
Page 349



S-DT2 SKT
Speed switch
Page 328



RTRD / RTRDU
Speed control
Page 335



RTRE
Speed control
Page 332



REU
Speed control
Page 332



REE
Speed control
Page 333



REV
On/off switch
Page 360



FRQ
Frequency inverter
Page 338

Quick selection (90° airflow)

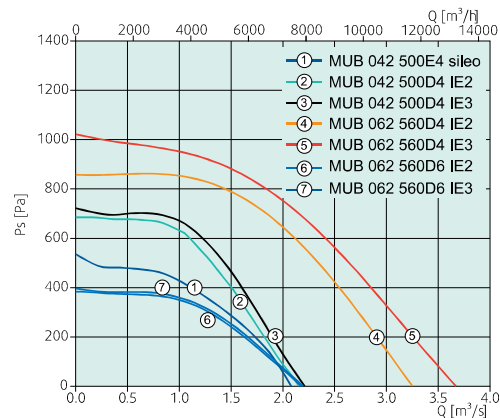
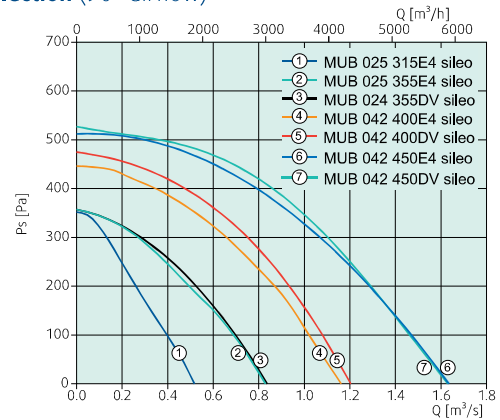

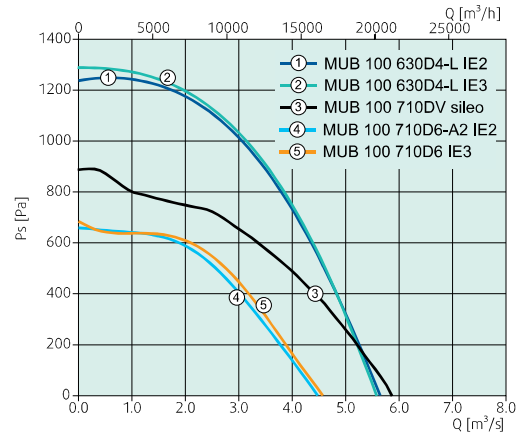
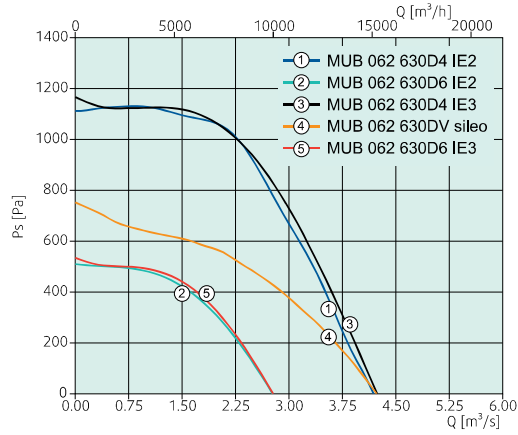

Dimensions

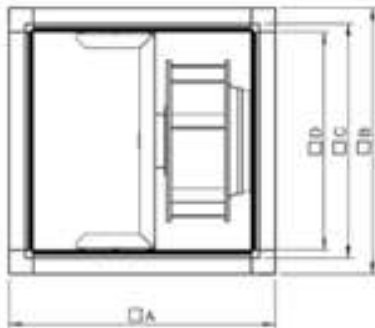

MUB	□A	□B	□C	□D
MUB025 315	500	500	420	378
MUB025 355	500	500	420	378
MUB042 400	670	670	590	548
MUB042 450	670	670	590	548
MUB042 500	670	670	590	548
MUB062 560	800	800	720	678
MUB062 630	800	800	720	678
MUB100 630	1000	1000	920	878
MUB100 710	1000	1000	920	878

Technical data (90° airflow)

MUB	MUB 025 315E4 sileo	MUB 025 355DV sileo Multibox	MUB 025 355E4 sileo Multibox
Art. no.	78171	37728	37769
Voltage	V 1x230	3x400	1x230
Frequency	Hz 50	50	50
Input power (P1)	W 139	267	267
Current	A 0.66	0.5	1.13
Max. temperature of transported air	°C 60	60	60
* when speed-controlled	°C 60	60	60
Sound pressure level (1 m)*	dB(A) 37	47	55
Weight	kg 27.1	30	30
Insulation class	B	F	F
Capacitor	µF 4	-	6

(*) Free field conditions

Technical data (90° airflow)

MUB		MUB 042 400E4 sileo	MUB 042 400DV sileo	MUB 042 450DV sileo	MUB 042 450E4 sileo
Art. no.		37886	37888	37885	37908
Voltage	V	1x230	3x400	3x400	1x230
Frequency	Hz	50	50	50	50
Input power (P1)	W	469	513	712	737
Current	A	2.24	1.22	1.36	3.04
Max. temperature of transported air	°C	60	60	60	60
* when speed-controlled	°C	60	60	60	60
Sound pressure level (1 m)*	dB(A)	43	53.5	60	48
Weight	kg	52.5	51.5	55	54.5
Insulation class		F	F	F	F
Capacitor	µF	9	-	-	14

MUB		MUB 042 500D4 IE2	MUB 042 500D4 IE3	MUB 042 500E4 sileo
Art. no.		33542	37351	37901
Voltage	V	3x400	3x400	1x230
Frequency	Hz	50	50	50
Input power (P1)	W	1356	1452	1137
Current	A	2.87	2.89	5.32
Max. temperature of transported air	°C	40	40	60
* when speed-controlled	°C	-	-	60
Sound pressure level (1 m)*	dB(A)	51	61	50
Weight	kg	64	65.5	64
Insulation class		F	F	F
Capacitor	µF	-	-	30

MUB		MUB 062 560D4 IE2	MUB 062 560D4 IE3	MUB 062 560D6 IE2	MUB 062 560D6 IE3
Art. no.		33543	37352	33544	87943
Voltage	V	3x400	3x400	3x400	3x400
Frequency	Hz	50	50	50	50
Input power (P1)	W	2437	2862	770	752
Current	A	4.27	4.69	1.71	1.64
Max. temperature of transported air	°C	40	40	40	40
* when speed-controlled	°C	-	-	-	-
Sound pressure level (1 m)*	dB(A)	52	66	43	54
Weight	kg	92	102	85	86.2
Insulation class		F	F	F	F
Capacitor	µF	-	-	-	-

(*) Free field conditions

Technical data (90° airflow)

MUB		MUB 062 630D4 IE2	MUB 062 630D4 IE3	MUB 062 630D6 IE2	MUB 062 630D6 IE3	MUB 062 630DV sileo
Art. no.		33545	37353	33546	87944	37909
Voltage	V	3x400	3x400	3x400	3x400	3x400
Frequency	Hz	50	50	50	50	50
Input power (P1)	W	4411	4206	1407	1281	2642
Current	A	7.67	7.22	3.36	2.81	4.62
Max. temperature of transported air	°C	40	40	40	40	45
* when speed-controlled	°C	40	40	40	40	45
Sound pressure level (1 m)*	dB(A)	64	68	56	57	65
Weight	kg	104	110	95	97	87
Insulation class		F	F	F	F	F
Capacitor	µF	-	-	-	-	-

MUB		MUB 100 630D4-L IE2	MUB 100 630D4-L IE3
Art. no.		33549	87945
Voltage	V	3x400	3x400
Frequency	Hz	50	50
Input power (P1)	W	5477	5337
Current	A	9.54	8.7
Max. temperature of transported air	°C	40	40
* when speed-controlled	°C	-	-
Sound pressure level (1 m)*	dB(A)	70	64
Weight	kg	177	181
Insulation class		F	F
Capacitor	µF	-	-

MUB		MUB 100 710D6 IE3	MUB 100 710D6-A2 IE2	MUB 100 710DV sileo
Art. no.		87946	33548	48581
Voltage	V	3x400	3x400	3x400
Frequency	Hz	50	50	50
Input power (P1)	W	2504	2444	4075
Current	A	4.65	5.03	6.51
Max. temperature of transported air	°C	40	60	55
* when speed-controlled	°C	-	-	55
Sound pressure level (1 m)*	dB(A)	60	55	73
Weight	kg	150	148	143
Insulation class		F	F	F
Capacitor	µF	-	-	-

(*) Free field conditions

MUB EC



- 100% speed-controllable
- Integrated electronic motor protection
- Low noise level
- Installation in any position
- Safe and maintenance free operation
- Potentiometer included for ease of commissioning

EC Square duct fans

Casing

Self-supporting aluminium frame construction with high impact resistant PA6 corners. 20 mm or 30 mm mineral wool acoustic and thermal insulation.

Motor

Energy-saving, highly efficient EC external rotor motors.

Impeller geometry

Centrifugal impeller with backward curved blades.

Output control

100 % controllable via a 0-10 V signal. The fans are equipped with a potentiometer (0-10 V), installed in the terminal box. The speed can be easily adjusted should the installation require a different operation point.

Motor protection

The motor protection is integrated in the motor electronics.

You can find more information in our online catalogue on www.systemair.com

Accessories



CCM
Connection
Page 387



CCMI
Connection, iso.
Page 387



FGV
Flex. connection
Page 385



SD-MUB
Vibration pad
Page 388



SRKG
Shutter
Page 375



UGS
Flexible adapter
Page 386



WSD MUB
Weather roof
Page 386



WSG
Weather protection
Page 386

Electrical accessories



CO2RT
Transmitter
Page 345



CXE
Digital regulator
Page 346



EC-Vent/Basic
Control unit
Page 343



HR1
Room Humidistat
Page 356



MTP
Speed control
Page 336



MTV
Speed control
Page 336



REV
On/off switch
Page 360



RT
Room Thermostat
Page 355

Quick selection (90° airflow)

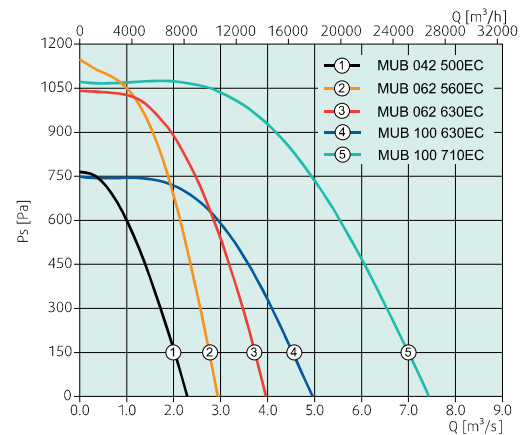
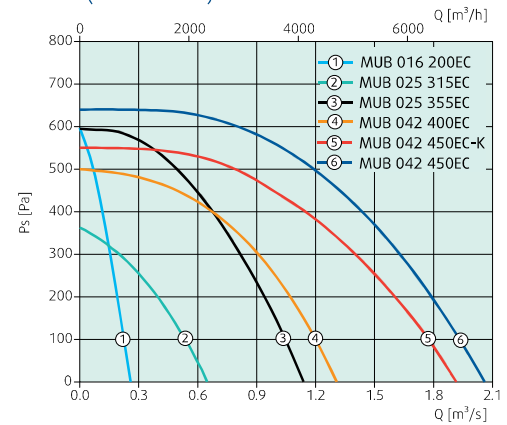

Dimensions

MUB 016

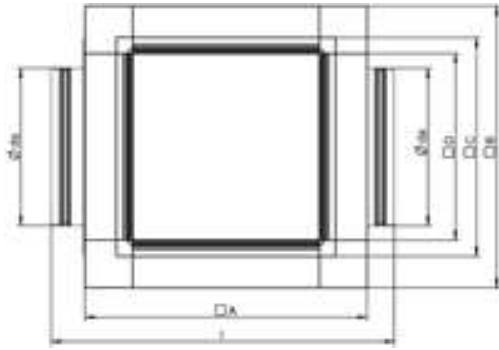

MUB 025-100

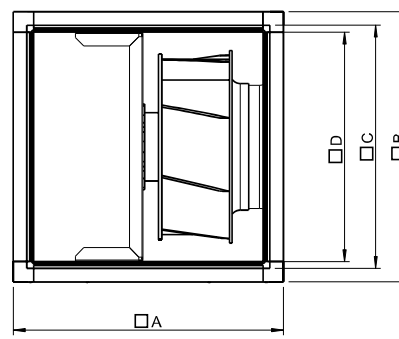

MUB EC	A	B	C	D	da	l
MUB 016 200EC	358	358	278	237	200	435

MUB EC	A	B	C	D
MUB 025 315EC Multibox	500	500	420	378
MUB 025 355EC Multibox	500	500	420	378
MUB 042 400EC Multibox	670	670	590	548
MUB 042 450EC Multibox	670	670	590	548
MUB 042 450EC-K Multibox	670	670	590	548
MUB 042 500EC Multibox	670	670	590	548
MUB 062 560EC Multibox	800	800	720	678
MUB 062 630EC Multibox	800	800	720	678
MUB 100 630EC Multibox	1000	1000	920	878
MUB 100 710EC Multibox	1000	1000	920	878

Technical data (90° airflow)

MUB EC		MUB 016 200EC	MUB 025 315EC	MUB 025 355EC	MUB 042 400EC	MUB 042 450EC	MUB 042 450EC-K
Art. no.		76866	79206	79207	79208	79209	84601
Voltage	V	1x230	1x230	1x230	1x230	3x400	1x230
Frequency	Hz	50/60	50/60	50/60	50/60	50/60	50/60
Input power (P1)	W	155	157	526	537	991	768
Current	A	1.24	1.26	2.21	2.29	1.45	3.22
Max. temperature of transported air	°C	55	60	60	55	60	60
Sound pressure level (1 m)*	dB(A)	52	41	47	44	54	51
Sound pressure level (3 m)*	dB(A)	42.5	31.5	37.5	34.5	44.5	41.5
Weight	kg	15	27.1	29.8	50	54	51.8
Insulation class		B	B	F	F	F	F
Speed control ⁽¹⁾	electr.	CXE/AVC	CXE/AVC	CXE/AVC	CXE/AVC	CXE/AVC	CXE/AVC
Speed control ⁽¹⁾	electr.	MTP 10	MTP 10	MTP 10	MTP 10	MTP 10	MTP 10

MUB EC		MUB 042 500EC	MUB 062 560EC	MUB 062 630EC	MUB 100 630EC	MUB 100 710EC
Art. no.		79231	79232	79233	37400	37401
Voltage	V	3x400	3x400	3x400	3x400	3x400
Frequency	Hz	50/60	50/60	50/60	50/60	50/60
Input power (P1)	W	1315	2623	3172	2924	6434
Current	A	1.96	3.79	4.6	4.3	8.96
Max. temperature of transported air	°C	55	60	55	60	40
Sound pressure level (1 m)*	dB(A)	52	53	63	64	70
Sound pressure level (3 m)*	dB(A)	42.5	43.5	53.5	54.5	60.5
Weight	kg	57.5	83.5	87.8	148	176
Insulation class		F	F	F	F	F
Speed control ⁽¹⁾	electr.	CXE/AVC	CXE/AVC	CXE/AVC	CXE/AVC	CXE/AVC
Speed control ⁽¹⁾	electr.	MTP 10	MTP 10	MTP 10	MTP 10	MTP 10

(*) Free field conditions

(1) Systemair recommendation.